

AWWA STANDARD STEEL - RING FLANGE (86PSI*)

TABLE 2 CLASS B (BLINDS FROM TABLE 7)

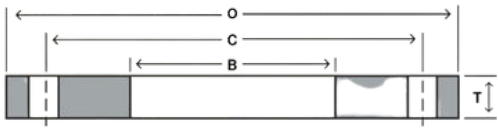

Nom Size	Thickness				Drilling			Weight	
	OD	Slip-On	Blind	Bore	Bolt Circle	Hole Dia	# of Holes	Slip-on	Blind
	O	T	T	B	C				
4	9	0.625	0.625	4.57	7.5	0.75	8	8	11
5	10	0.625	0.625	5.66	8.5	0.875	8	9	14
6	11	0.688	0.688	6.72	9.5	0.875	8	11	19
8	13.5	0.688	0.688	8.72	11.75	0.875	8	15	28
10	16	0.688	0.688	10.88	14.25	1	12	19	39
12	19	0.688	0.719	12.88	17	1	12	28	58
14	21	0.688	0.791	14.19	18.75	1.125	12	34	78
16	23.5	0.688	0.892	16.19	21.25	1.125	16	41	110
18	25	0.688	0.95	18.19	22.75	1.25	16	41	132
20	27.5	0.688	1.04	20.19	25	1.25	20	49	175
22	29.5	0.75	1.132	22.19	27.25	1.375	20	57	219
24	32	0.75	1.216	24.19	29.5	1.375	20	67	277
26	34.25	0.812	1.307	26.19	31.75	1.375	24	80	341
28	36.5	0.875	1.398	28.19	34	1.375	28	94	414
30	38.75	0.875	1.477	30.19	36	1.375	28	105	493
32	41.75	0.936	1.581	32.19	38.5	1.625	28	132	613
34	43.75	0.938	1.661	34.19	40.5	1.625	32	137	707
36	46	1	1.751	36.19	42.75	1.625	32	161	824
38	48.75	1	1.853	38.19	45.25	1.625	32	185	980
40	50.75	1	1.933	40.19	47.25	1.625	36	193	1108
42	53	1.125	2.023	42.19	49.5	1.625	36	234	1264
44	55.25	1.125	2.114	44.19	51.75	1.625	40	249	1436
46	57.25	1.125	2.194	46.19	53.75	1.625	40	260	1600
48	59.5	1.25	2.285	48.19	56	1.625	44	306	1800
50	61.75	1.25	2.377	50.19	58.25	1.875	44	317	2017
52	64	1.25	2.468	52.19	60.5	1.875	44	339	2249
54	66.25	1.375	2.559	54.19	62.75	1.875	44	397	2499
60	73	1.5	2.82	60.19	69.25	1.875	52	508	3344
66	80	1.625	3.092	66.19	76	1.875	52	664	4403
72	86.5	1.75	3.353	72.19	82.5	1.875	60	802	5582
78	93	2	78.19	89	2.125	64	1000
84	99.75	2	84.19	95.5	2.125	64	1145
90	106.5	2.25	90.19	102	2.438	68	1404
96	113.25	2.25	96.19	108.5	2.438	68	1586
102	120	2.5	102.19	114.5	2.688	72	1912
108	126.75	2.5	108.19	120.75	2.688	72	2136
114	133.5	2.75	114.19	126.75	2.938	76	2525
120	140.25	2.75	120.19	132.75	2.938	76	2795
126	147	3	126.19	139.25	3.188	80	3252
132	153.75	3	132.19	145.75	3.188	80	3572
138	160.5	3.25	138.19	152	3.438	84	4101
144	167.25	3.25	144.19	158.25	3.438	84	4475

*PRESSURE RATING AT ATMOSPHERIC TEMPERATURE IS 86 PSI. THESE FLANGES HAVE THE SAME OD AND DRILLING AS ANSI/ASME B16.1. CLASS 125 CAST IRON FLANGES. IN SIZES 24" AND SMALLER, THEY ALSO MATCH ANSI/ASME B16.5 150-PSI STANDARD FOR STEEL FLANGES.

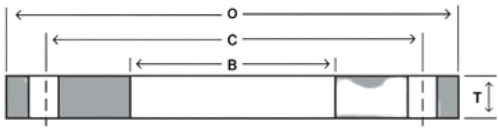

AWWA STANDARD STEEL - RING FLANGE (175-150PSI*)

TABLE 2 CLASS D (BLINDS FROM TABLE 7)

Nom Size	Thickness			Bore	Drilling			Weight	
	OD	Slip-On	Blind		Bolt Circle	Hole Dia	# of Holes	Slip-on	Blind
	O	T	T		C				
4	9	0.625	0.625	4.57	7.5	0.75	8	8	11
5	10	0.625	0.65	5.66	8.5	0.875	8	9	14
6	11	0.688	0.693	6.72	9.5	0.875	8	11	19
8	13.5	0.688	0.812	8.72	11.75	0.875	8	15	33
10	16	0.688	0.953	10.88	14.25	1	12	19	54
12	19	0.812	1.117	12.88	17	1	12	33	90
14	21	0.938	1.133	14.19	18.75	1.125	12	47	111
16	23.5	1	1.265	16.19	21.25	1.125	16	60	155
18	25	1.062	1.331	18.19	22.75	1.25	16	64	185
20	27.5	1.125	1.448	20.19	25	1.25	20	79	244
22	29.5	1.188	1.568	22.19	27.25	1.375	20	90	304
24	32	1.25	1.661	24.19	29.5	1.375	20	112	378
26	34.25	1.312	1.786	26.19	31.75	1.375	24	129	466
28	36.5	1.312	1.906	28.19	34	1.375	28	141	565
30	38.75	1.375	2.008	30.19	36	1.375	28	164	671
32	41.75	1.5	2.15	32.19	38.5	1.625	28	211	834
34	43.75	1.5	2.252	34.19	40.5	1.625	32	220	959
36	46	1.625	2.37	36.19	42.75	1.625	32	261	1116
38	48.75	1.625	2.506	38.19	45.25	1.625	32	301	1325
40	50.75	1.625	2.609	40.19	47.25	1.625	36	313	1438
42	53	1.75	2.729	42.19	49.5	1.625	36	364	1706
44	55.25	1.75	2.849	44.19	51.75	1.625	40	387	1935
46	57.25	1.75	2.952	46.19	53.75	1.625	40	404	2153
48	59.5	1.875	3.072	48.19	56	1.625	44	460	2420
50	61.75	2	3.196	50.19	58.25	1.875	44	507	2712
52	64	2	3.315	52.19	60.5	1.875	44	542	3021
54	66.25	2.125	3.435	54.19	62.75	1.875	44	614	3355
60	73	2.25	3.779	60.19	69.25	1.875	52	763	4481
66	80	2.5	4.136	66.19	76	1.875	52	1021	5890
72	86.5	2.625	4.48	72.19	82.5	1.875	60	1203	7458
78	93	2.75	78.19	89	2.125	64	1374
84	99.75	2.875	84.19	95.5	2.125	64	1646
90	106.5	3	90.19	102	2.438	68	1872
96	113.25	3.25	96.19	108.5	2.438	68	2291
102	120	3.25	102.19	114.5	2.688	72	2485
108	126.75	3.375	108.19	120.75	2.688	72	2884
114	133.5	3.5	114.19	126.75	2.938	76	3214
120	140.25	3.5	120.19	132.75	2.938	76	3558
126	147	3.75	126.19	139.25	3.188	80	4065
132	153.75	3.875	132.19	145.75	3.188	80	4614
138	160.5	4	138.19	152	3.438	84	5047
144	167.25	4.125	144.19	158.25	3.438	84	5680

*PRESSURE RATING AT ATMOSPHERIC TEMPERATURE: SIZES 4-12 IN. INCLUSIVE, 175 PSI; SIZES LARGER THAN 12 IN., 150 PSI. THESE FLANGES HAVE THE SAME OD AND DRILLING AS ANSI/ASME B16.1 CLASS 125 CAST-IRON FLANGES.